

**CERTIFIED RECORD OF LAND CORNER MONUMENTATION**

USDA-FOREST SERVICE

Index File No. D-15  
 T 16 S R. 34 E  
 Merid. Willamette

**CORNER RECORD (SEARCH)**  
 (Ref. FSM 7151.4)

R.D. Prairie City County Grant  
 N.F. Malheur State Or.

Tract or Survey No. \_\_\_\_\_ Cor. No. CS 1/16

**CORNER DIAGRAM**

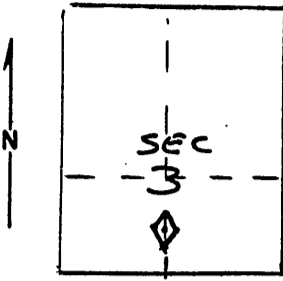

**DESCRIBE CORNER MONUMENT FOUND**

*NO GLO SET*

**DESCRIBE BEARING TREES OR OTHER OFFICIAL ACCESSORIES FOUND**

*NONE*

**PHOTO IDENTIFICATION DATA**

Photo No. \_\_\_\_\_  
 Filed At \_\_\_\_\_

**CORNER RECORD (PERPETUATION)**

**MONUMENT: DESCRIBE NEW MONUMENT SET, OR WORK DONE TO PRESERVE EXISTING MONUMENT**

2 1/2" X 30" alum. pipe with alum. cap set 24" in ground.  
 Cap stamped as shown. *NO STONE NEAR.*



**ACCESSORIES: DESCRIBE NEW BT'S WITNESS OBJECTS ETC. ESTABLISHED, OR WORK DONE TO PRESERVE EXISTING EVIDENCE**

Steel fence posts with signs set 5' North and 5' West of corner.

*NO TREES NEAR.*

Work Done By R.H. Schulson Title Land Surveyor Date 8-83 State Registration No. #1658  
 or Agency \_\_\_\_\_

Certified Cor. Record Prepared? Yes No  Filed At: \_\_\_\_\_ Date \_\_\_\_\_

**REMARKS**

Witnessed by: Randall Schulson

Index File No. D-15 T. 16S R. 34E M. Tract or Surv. No. \_\_\_\_\_ Cor. CS 1/16

SEP 16 1983

REGISTERED PROFESSIONAL LAND SURVEYOR

*Ronald H. Schulson*

OREGON  
 JULY 14, 1978  
 RONALD H. SCHULSON  
 1658

Office of..... County Surveyor..... County of..... Grant.....  
 State of..... Oregon....., I hereby certify that the within instrument was filed in this office  
 for record on the 30 day of Sept, 1983  
*Robert D. Day* by \_\_\_\_\_  
 (COUNTY OFFICIAL) (DEPUTY)